

TUDA PROCEEDING
NO.1166/0010/LP/Tuda/2018



Luxury life style villas for peace and harmony





STHITHA GROUP, We are into real estate building apartments, developing residential layouts from last one decade Bangalore India Now we are launching our 2 new projects in Tiripathi (upcoming smart city)CHITTOOR DIST, AP

STHITHA GRAND - LUXURY VILLAS

STHITHA GATEWAY - RESIDENTIAL TOWNSHIP - upcoming project

We at Sthitha Group understand customer freedom, hence we have designed the villas to give you freedom of space an happiness and is planned as per the guidelings of vaastu shastra. We have tried to create a space where every breath relaxes you even more expect lasting luxury, comfort & glamorous. A life style f a diferent level



STHITHA
GROUP



STHITHA
Grone





Ground Floor

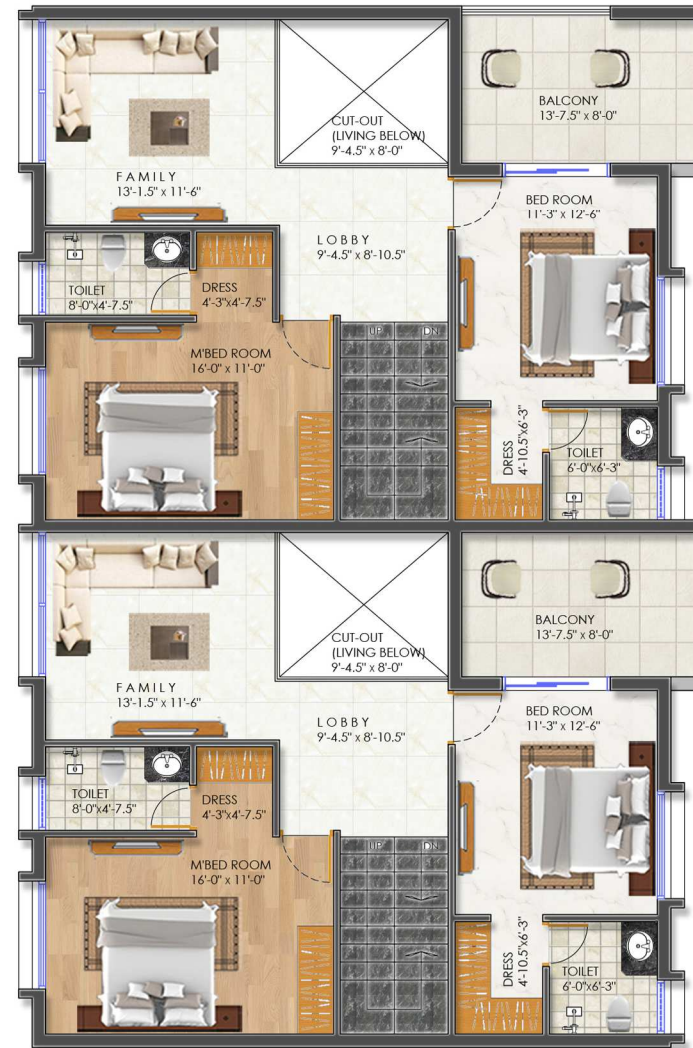

First Floor



Twin Villas





Ground Floor



First Floor

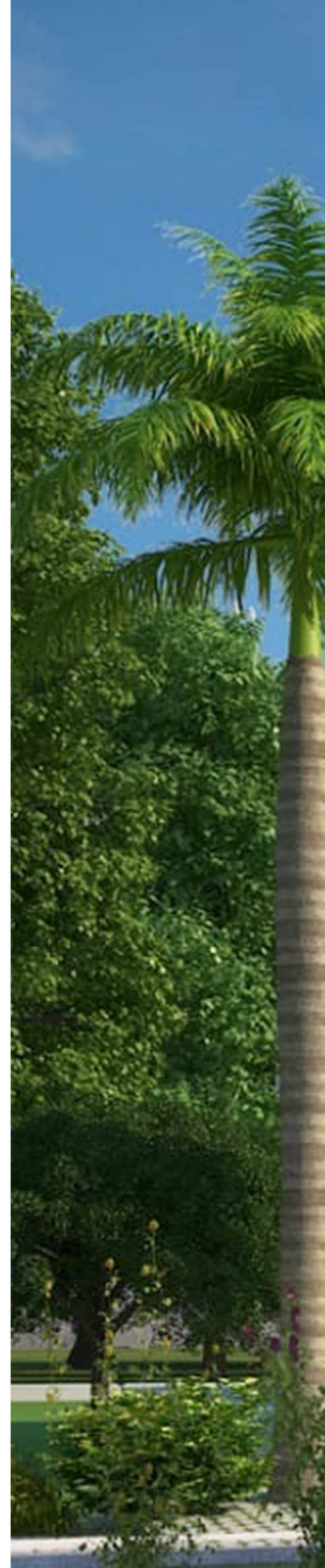

West Facing Villa





Ground Floor



N

First Floor



East Facing Villa



SPECIFICATION

Structure	RCC framed structure as per architect using Fe 500 steel TMT bars, outside 9inch and inside 4inch Red brick walls.
Doors	All Doors with Teak frames, main door with Teak, remaining doors with Water proof veneer finishing.
Windows	Heavy gauged UPVC frames with glazed, sliding shutters with mosquito mesh and mild steel grills.
Flooring	Vitrified tile flooring in Hall, Dining kitchen, Bedrooms of size 800x1200 mm and one Master bedroom with Wooden Flooring, inside stair cases with granite slabs.
Kitchen Platform	Granite platform with stainless steel sink and 2' height Ceramic Tiles dado above granite platform.
Toilets	Ceramic tiles dado up to 7'. Parry ware or Equivalent sanitary fittings. Good Quality C.P Fittings. Provision for geyser and exhaust fan in all bathrooms. Solar water provision for bathrooms.
Painting	Interior: Two coats of wall putty, one coat of wall primer with emulsion of reputed brand. Exterior: One coat of wall primer with one coat of acrylic weather coat paint of reputed brand as per elevation

EAST FACING VILLA

	PLINTH AREA	BALCONY / PORTICO / Slab Projection	CUT-OUT	TOTAL
GROUND FLOOR	883.50	208.00	---	1091.50
FIRST FLOOR	910.80	134.00	56.85	987.95
TERRACE FLOOR	120.00	50.00	---	170.00
TOTAL	1914.30	392.00	56.85	2249.45



WEST FACING VILLA

	PLINTH AREA	BALCONY / PORTICO / Slab Projection	CUT-OUT	TOTAL
GROUND FLOOR	882.50	259.00	---	1141.50
FIRST FLOOR	911.00	133.93	97.50	947.43
TERRACE FLOOR	134.50	53.50	---	188.00
TOTAL	1928.00	446.43	97.50	2276.93





LOCATED

- a. 1/2 km from Bangalore Renigunta Highway
- b. 7 kms from Tirupati RTC Busstand
- c. 10 kms from Airport
- d. 3 kms. from Chennai Highway
- e. 3 kms from Tiruchanur Ammawari Temple





AMENITIES

- a. Club House
- b. Children Play Area
- c. Solar for Common Area

- d. 24hrs Security
- e. Well Equiped Gym
- f. Swimming Pool

- g. STP
- h. CCTV for Security & Common Areas
- i. 24hrs Water
- j. Concrete Roads



◊C◊O◊M◊P◊L◊E◊T◊E◊D◊ ◊P◊R◊O◊E◊J◊C◊T◊S◊



Teja Residency ~ I



Teja Residency ~ III



Teja Residency ~ II



Sai Teja Garden

LOCATION





+91 88866 40051

+91 88866 40052



STHITHA INFRA PVT LTD

No. 9, Teja Residency-3
Coconut Garden, Ayyappanagar
K P Puram
Bangalore-560 036



3-53, First Floor,
Srinivasapuram (Padmavathipuram)
Opp. to L V Kalyanamandapam
Thiruchanur Road, Thirupathi-517 503

vreddy@sthithagroup.com | www.sthithagroup.com

